



Packington Hall
Meriden, Warwickshire CV7 7HF

PACKINGTON
ESTATE

T: 01676 522020 F: 01676 523399
packingtonestate.co.uk

Marsh Lane Nature Reserve

SCALE : 1:5000 @ A3 DATE : 02/11/2022



MAP FILENAME : MLNR

Map data shown may contain Ordnance Survey® products supplied by Pear Technology Services Ltd; Email: info@peartechology.co.uk © Crown Copyright and database rights from date shown above Ordnance Survey® licence number 100023148

1. Entrance Gates (Locked)
2. Cottage Copse
3. Old (Kenilworth) Road Footpath
4. Reedbed
5. Cereals for Finches (crop field)
6. Islands
7. Grassland
8. Grassland with Scrapes (Lower Siden)
9. Railway Copse (Back Gate Copse)

- A. Railway Hide
- B. Oak Hide
- C. River Hide
- D. Car Park Hide
- E. Tower Hide (Locked)
- F. Lower Siden Hide (Locked)
- G. North Causeway and Reedbed Hides

△ Feeding Station

**what3words
emptied.lawn.seashell**

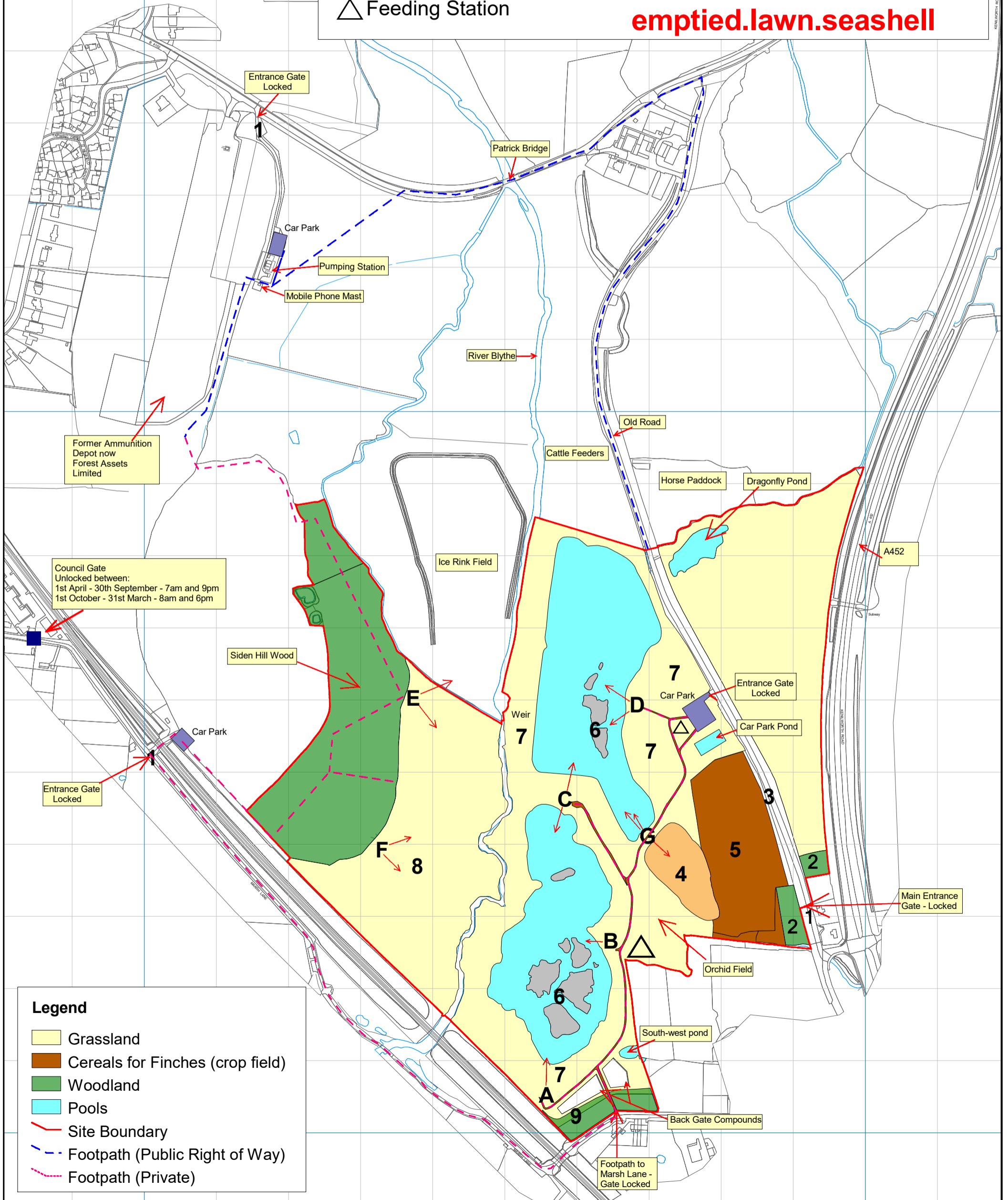

Legend

- Grassland
- Cereals for Finches (crop field)
- Woodland
- Pools
- Site Boundary
- Footpath (Public Right of Way)
- Footpath (Private)